

800 WOG/ PN55
SIZE: 1/4"-2"



SPECIFICATION

- * Body & end caps quality investment casting
- * Available in stainless steel or carbon steel
- * with ISO 5211 direct mounting pad
- * Adjustable stem packing
- * Blow-out proof stem design
- * Available in L-port or T-port
- * Available in full bore or reduced bore (std. bore)
- * 100% air tested under water at 80-100 psi
- * Temperature range -20°F to 450°F
- * End type: thread
- * with locking function

OPTION

- * Automation application
- * PTFE/ PFA coating (40-70 um)
- * TFM1600/ TFM4215/ UPE (UHMWP) soft kits

ZIPSON'S 501S, 3-way ball valve with ISO direct mount is the most popular & ripe type in the product line. The 501S designed with ISO direct mount for assembling the actuator directly.

501S is 4 seats design, this will help to keep the ball position stably. And designed with a insert pin between the stem & ball to make sure the ball will not leaning after hundreds of operation. The 4 windows on the neck will let the media leak from while the valve leaks. This will protect the actuator to keep from damage by the media. And a good way to keep the working temperature lower, this will help to increase the life time of actuator.

As for the soft kits, pure PTFE/ PTFE+25% Carbon/ TFM1600/ TFM4215/ UPE (UHMWPE) are available for different application.

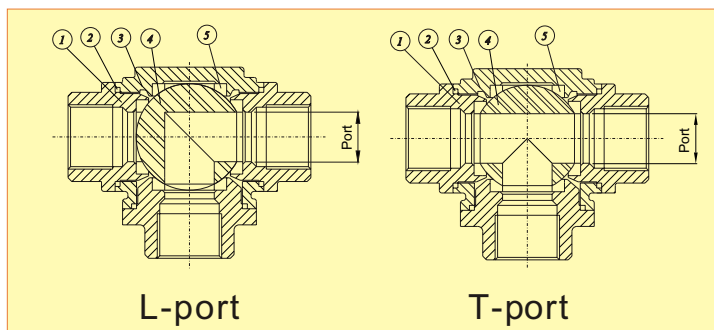

L-port

T-port

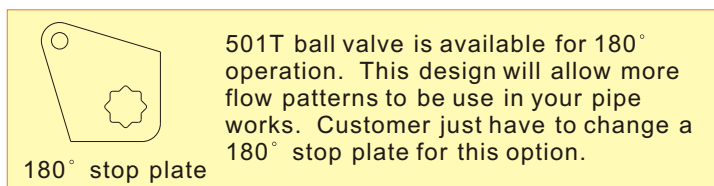

180° stop plate

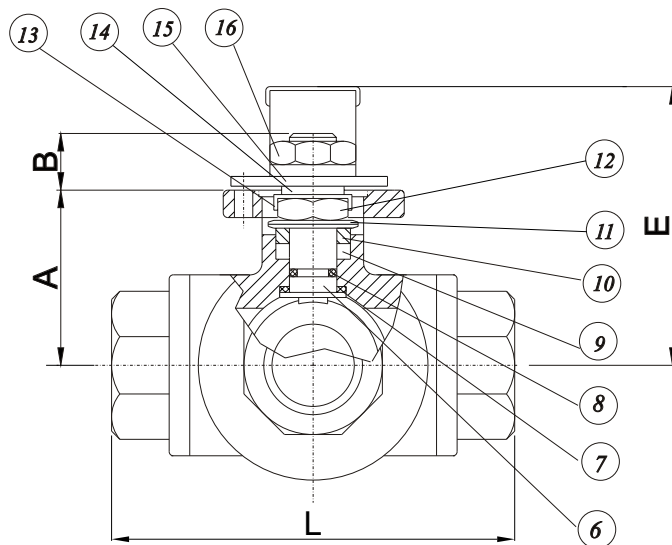
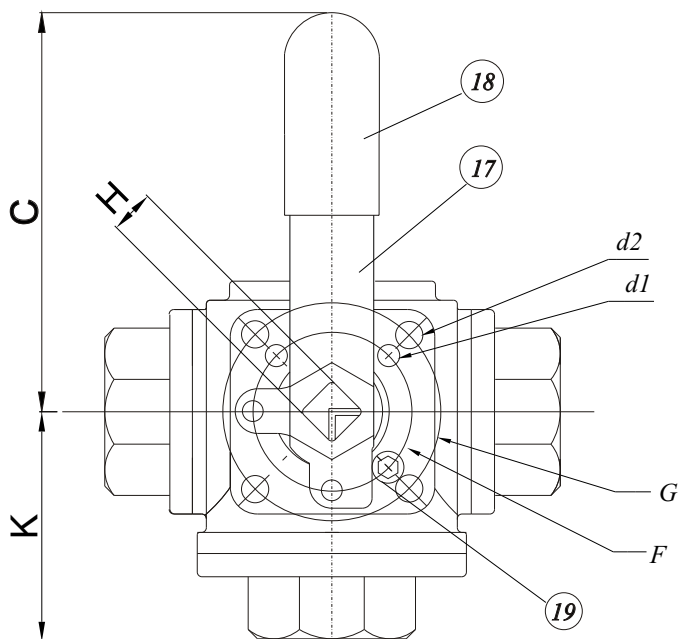

DIMENSIONS (mm)

FULL PORT	STD. PORT	A	B	C	d1	d2	E	F	G	H	K	L	Port	FULL W(kg)	STD. W(kg)
1/4"	*	37	9.5	130	6.0	6.0	62	36	42	9	35	72	11	0.66	0.66
3/8"	1/2"	37	9.5	130	6.0	6.0	62	36	42	9	35	72	12	0.66	0.66
1/2"	3/4"	42	11	130	6.0	6.0	64	36	42	9	40.5	84.5	15	0.86	0.66
3/4"	1"	49	14	165	6.0	7.1	82	42	50	11	49.5	100	20	1.48	0.86
1"	1 1/4"	55	14	165	6.0	7.1	89	42	50	11	56.5	113	25	2.22	1.52
1 1/4"	1 1/2"	63	17	205	7.1	9.2	98	50	70	14	62	125.5	32	3.22	2.18
1 1/2"	2"	74	16	205	7.1	9.2	108	50	70	14	73.5	150	38	5.36	3.38
2"	*	92	21	325	9.2	11.4	140	70	102	17	87	174	50	9.70	5.26

FLOW PATTERN

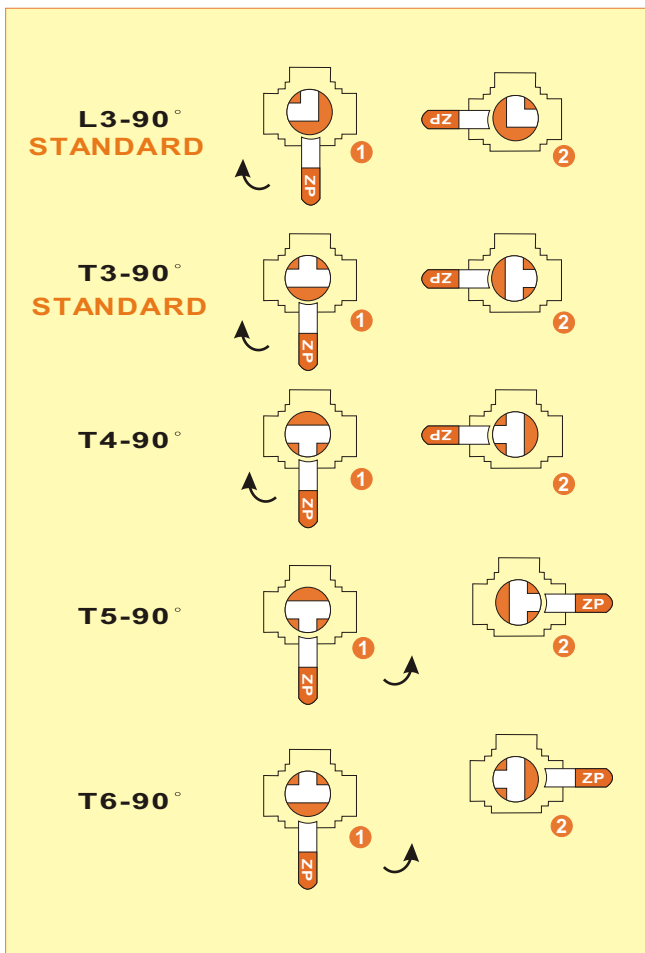

The wise use of 3-way or multi-way ball valve will help to save much cost on pipe line installation & the cost of place.

MATERIALS LIST

ITEM	PART NAME	MATERIALS
1	END CAP	CF8M
2	GASKET	PTFE
3	BODY	CF8M
4	BALL	SS 316
5	SEAT	PTFE
6	STEM	SS 316
7	THRUST WASHER	RPTFE
8	O-RING	VITON
9	STEM PACKING	PTFE
10	GLAND	SS 304
11	DISK WASHER	SS 301
12	STEM NUT	SS 304
13	NUT STOP	SS 304
14	SPACE WASHER	SS 304
15	STOPPER PLATE	SS 304
16	HANDLE UNT	SS 304
17	HANDLE	SS 304
18	SLEEVE	PLASTIC
19	STOP PIN	SS 304

PRESSURE/ TEMPERATURE

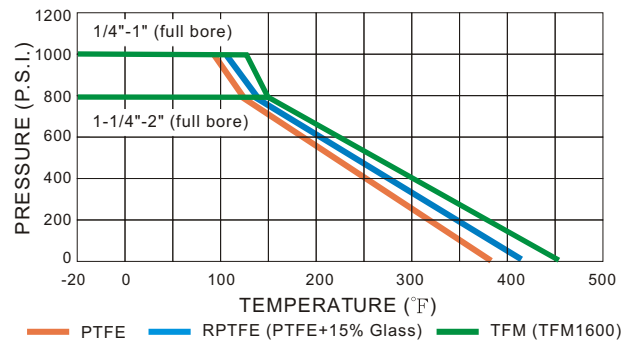

BREAK-TORQUE VALUE (Nm)

SIZE (FULL BORE)	1/4"	3/8"	1/2"	3/4"	1"	1-1/4"	1-1/2"	2"
SIZE (RED. BORE)	-	1/4"~1/2"	3/4"	1"	1-1/4"	1-1/2"	2"	-
GREASE	9	9	11	13	24	43	53	60
NON-GREASE	12	12	15	18	33	60	75	84

* Solenoid valve/ Limit Switch Box/ EP

Note 1: The greases ZIPSON use including lubricant & anti-seize grease are both SILICONE-FREE.

Note 2: Strongly suggest increasing at least 30%~40% for safety factor for mounting actuator.

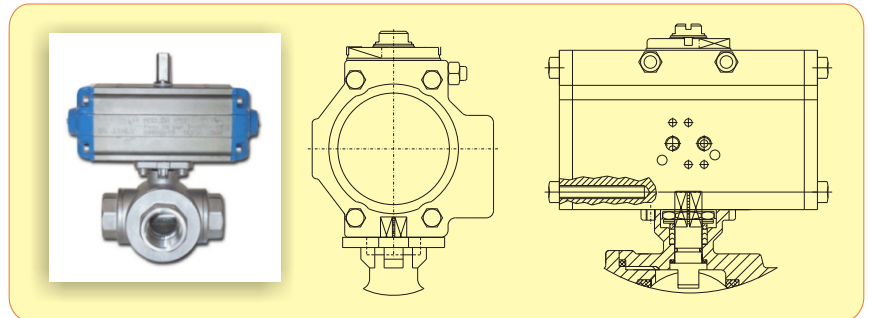
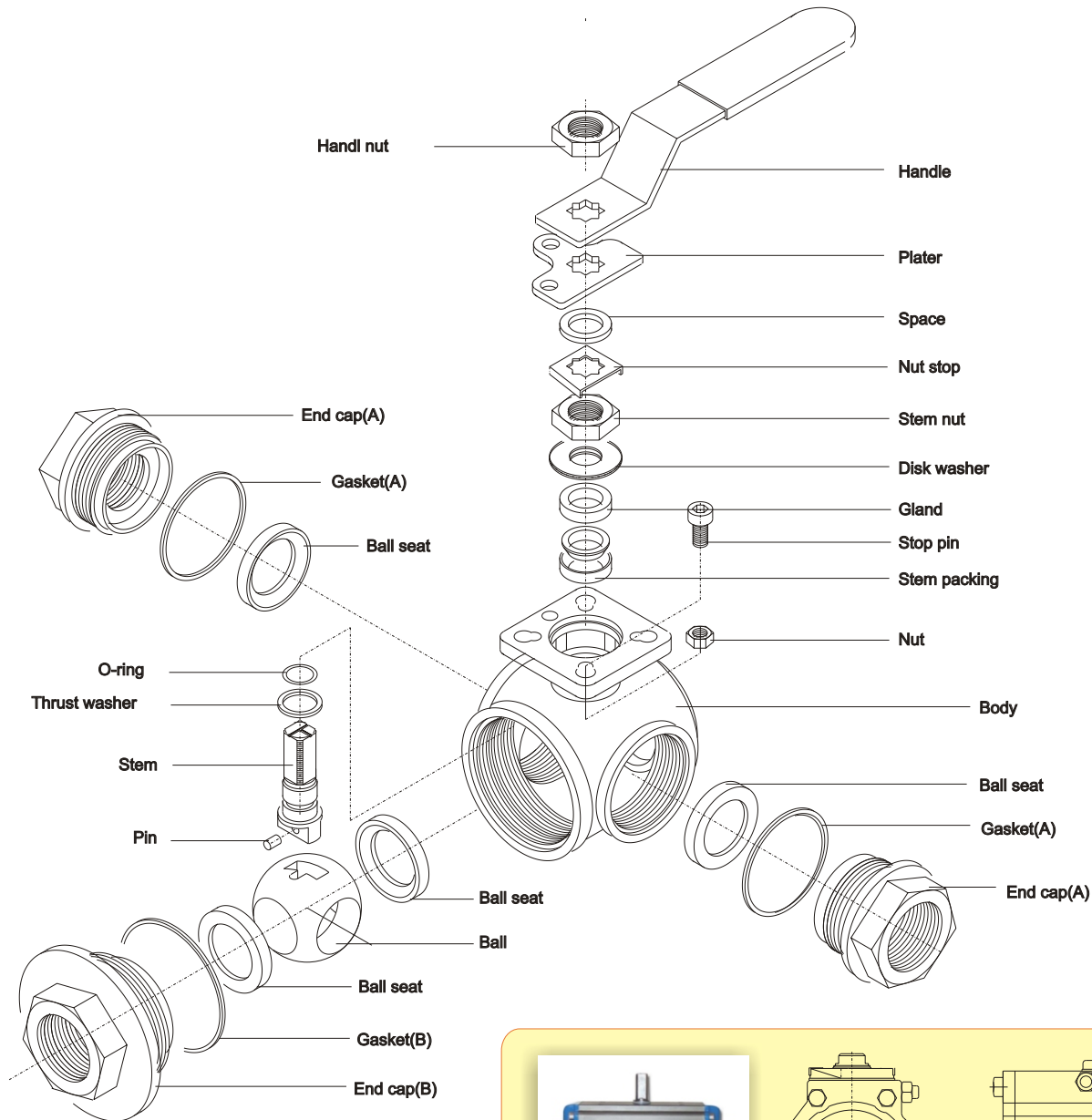

ISO direct mount for actuator assembling directly.

* Pneumatic (DA or SR)/ Electric actuator

CAUTION!

1. As dismantle the ball valve, don't forget to replace new Repair Kits, especially the gasket to prevent from leaking.
2. PTFE/TFM is better than RPTFE (+15% Glass) as operate the valve by actuator, for Glass fiber will hurt the ball and cause the torque value increasing.
3. Before welding, make sure the ends were dismantled for welding.
4. For multi-way valve, when the media is AIR and over 30 bar, please ask Zipson to make SS housing to protect the seat.