

WINDOW SIGHT GLASS DW12G – DW12SS

DESCRIPTION

For monitoring the right operation of a steam trap, in order to avoid leakages of live steam and, consequently, great energy losses, a sight glass is recommended to be installed downstream of the steam trap.

The double window DW12 sight glasses have been designed for this particular application. Connections are flanged.

OPTIONS: Mica shield discs for use with steam.

USE: Condensate pipes, downstream of the steam traps.

AVAILABLE MODELS:
DW12G – PN16 Cast iron.
DW12SS – PN16 Stainless steel.

SIZES: DN 15 to DN 150.

CONNECTIONS: Flanged EN1092-1/-2 PN16.

INSTALLATION: Horizontal or vertical installation.
See IMI – Installation and maintenance instructions.

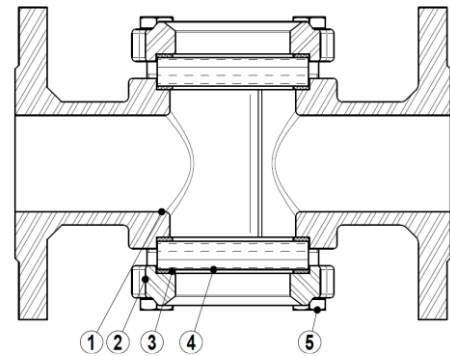
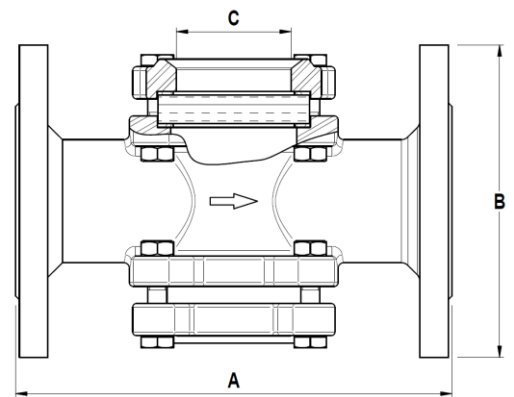

BODY LIMITING CONDITIONS			
DW12G		DW12SS	
ALLOWABLE PRESSURES	RELATED TEMPERATURE	ALLOWABLE PRESSURES	RELATED TEMPERATURE
16 bar	-10 / 120 °C	16 bar	-10 / 50 °C
14,4 bar	150 °C	14,5 bar	150 °C
12,8 bar	200 °C	13,4 bar	200 °C
11,8 bar	230 °C	12,9 bar	230 °C
10,5 bar	280 °C	12,2 bar	280 °C

For applications with steam, use mica shield discs.

DIMENSIONS (mm)					
SIZE DN	A	B	C	WEIGHT (kg)	
				DW12G	DW12SS
15	130	95	44	3	3
20	150	105	44	3,5	4
25	160	115	44	4	5
32	180	140	50	6	6,5
40	200	150	50	6,5	7,3
50	230	165	60	9	10,5
65	290	185	90	17	17
80	310	200	90	18	20
100	350	220	110	23	26,5
125	400	250	142	50	52
150	480	285	160	63	68

CE MARKING – GROUP 2 (PED – European Directive)	
PN16	Category
DN 15 to 50	SEP
DN 65 to 150	1 (CE marked)

MATERIALS			
POS. Nº	DESIGNATION	MATERIAL DW12G	MATERIAL DW12SS
1	Body	GJL-250 / 0.6025	CF8M / 1.4408
2	Cover	GJL-250 / 0.6025	CF8M / 1.4408
3	* Gasket	Graphite	Graphite
4	* Window glass	Borosilicate glass	Borosilicate glass
5	Bolts	Steel 8.8	A2-70

* Available spare parts.