

PRESSURE GAUGE MAN-100

DESCRIPTION

The MAN-100 pressure gauges have a diameter of 100 mm and are marked in bar.

MAIN FEATURES

Accuracy – Class 1.

OPTIONS: Available in multiple pressure ranges.

AVAIL. MODELS: MAN-100.

CONNECTIONS: 1/2" bottom or back eccentric.

MAX. MEASURING

RANGE: -1 to 40 bar.

WEIGHT: 0,34 kg.

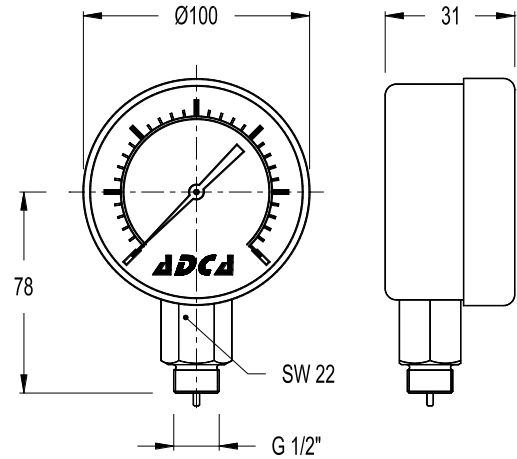

LIMITING CONDITIONS	
Max. allowable pressure	Full scale reading
Max. operating temperature	80 °C

MATERIALS	
DESIGNATION	MATERIAL
Case	AISI 304 / 1.4301
Lens	Glass
Dial	White aluminium
Pointer	Black aluminium
Measuring system	Copper alloy

GAUGE COCK GC-400

DESCRIPTION

GC-400 pressure gauge cocks (without test connection DIN 16270 Form A.)

AVAILABLE

MODELS: GC-400.

CONNECTIONS: 1/2" x 1/2" (male x female)

WEIGHT: 0,51 kg.

LIMITING

CONDITIONS: 250 bar at 250 °C;
400 bar at 120 °C.

MATERIALS	
DESIGNATION	MATERIAL
Body (steel)	1.0460 / P250GH
Body (st. steel)	1.4404 / AISI 316L
Spindle	Stainless steel
Packing	PTFE
Handwheel	Plastic

