

## SANITARY PRESSURE REDUCING VALVE P130A

### DESCRIPTION

The ADCA P130A series direct acting, air loaded, diaphragm sensing pressure reducing valves are designed for use with clean air, nitrogen, carbon dioxide, oxygen, argon and other gases or liquids compatible with the construction materials and valve design.

### MAIN FEATURES

Compact design.  
Completely machined from 316L stainless steel bar stock, no castings or forgings are used.  
Set point can be adjusted remotely using a relieving gas pressure regulator or through an I-P converter.  
Ease operation during the sterilization or cleaning process (SIP – CIP), by remotely increasing the set point, ensures that the valve stays totally open during the process.

### STANDARD SURFACE FINISH

Internal wetted parts:  $\leq 0,51$  micron Ra – SF1.  
External:  $\leq 0,76$  micron Ra – SF3.  
Other surface conditions see IS PV20.00 E – Technical information.  
Ultrasonic cleaning.

**OPTIONS:** Different soft valves for liquids and gases.  
Gauge connection on body.  
Wall mounting.

**USE:** Clean air, nitrogen, carbon dioxide, oxygen, argon and other gases or liquids compatible with the construction.

**AVAILABLE MODELS:** P130A.

**SIZES:** 1/2" to 1"; DN 08 to DN 25.

**OUTLET RANGE:** 0,2 – 8 bar.

**CONNECTIONS:** ASME BPE.  
Clamp ferrules or others on request.

**PACKAGING:** Assembling and packaging in a clean room certified according to ISO 14644-1.  
The product is end capped and sealed with recyclable thermo-shrinkable plastic film, to avoid contamination.

**INSTALLATION:** Horizontal installation recommended. See IMI.

### ORDER

**REQUIREMENTS:** Type of fluid.  
Maximum operating temperature.  
Inlet pressure and required outlet pressure  
Capacity (maximum and minimum).

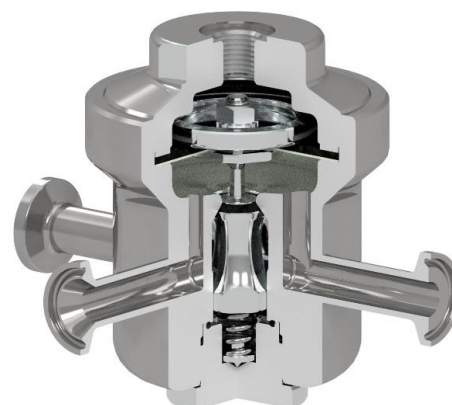

LIMITING CONDITIONS	
<b>Valve model</b>	<b>P130A</b>
Body design conditions	PN16
Max. upstream pressure	16 bar
Max. downstream pressure	8 bar
Min. downstream pressure	0,2 bar
Max. design temperature *	150 °C

\* Other on request.

CE MARKING – GROUP 2 (PED – European Directive)	
<b>PN16</b>	<b>Category</b>
1/2" to 1" ; DN 08 to DN 25	SEP

**DIMENSIONS (mm) ASME BPE**

SIZE	Kvs *	A **	B	C	D	d1 **	d2 **	d3 **	E	F	H	WEIGHT (kg)
1/2"	1,7	130	36,5	62	80	1/4"	25	15,75	65	25	9,4	2,9
3/4"	3	130	36,5	62	80	1/4"	25	15,75	67,5	25	15,75	2,9
1"	3	130	36,5	62	80	1/4"	25	15,75	72,5	50,5	22,1	3,4

**DIMENSIONS (mm) DIN**

SIZE DN	Kvs *	A **	B	C	D	d1 **	d2 **	d3 **	E	F	H	WEIGHT (kg)
10	1,7	120	36,5	62	80	1/4"	25	15,75	65	34	10	2,9
15	3	120	36,5	62	80	1/4"	25	15,75	67,5	34	16	3
20	3	120	36,5	62	80	1/4"	25	15,75	67,5	34	20	3,1
25	3	120	38,5	60	80	1/4"	25	15,75	72,5	50,5	26	3,4

Clamp ferrules DIN 32676 Series A; Tube weld DIN 11866 Series A (DIN 11850 Series 2).

**DIMENSIONS (mm) ISO**

SIZE DN	Kvs *	A **	B	C	D	d1 **	d2 **	d3 **	E	F	H	WEIGHT (kg)
8	1,7	120	36,5	62	80	1/4"	25	15,75	65	25	10,3	2,9
10	3	120	36,5	62	80	1/4"	25	15,75	67,5	25	14	3
15	3	120	36,5	62	80	1/4"	25	15,75	67,5	50,5	18,1	3,2
20	3	120	38,5	60	80	1/4"	25	15,75	72,5	50,5	23,7	3,4

Clamp ferrules DIN 32676 Series B; Tube weld DIN 11866 Series B (ISO 1127 Series 1).

\* Reduced Kvs on request.

\*\* Special versions or non-standard sanitary clamp ferrules are available on request, both for the inlet/outlet and pressure gauge connection.

Valves with vinyl handwheel weights less 0,3 kg.

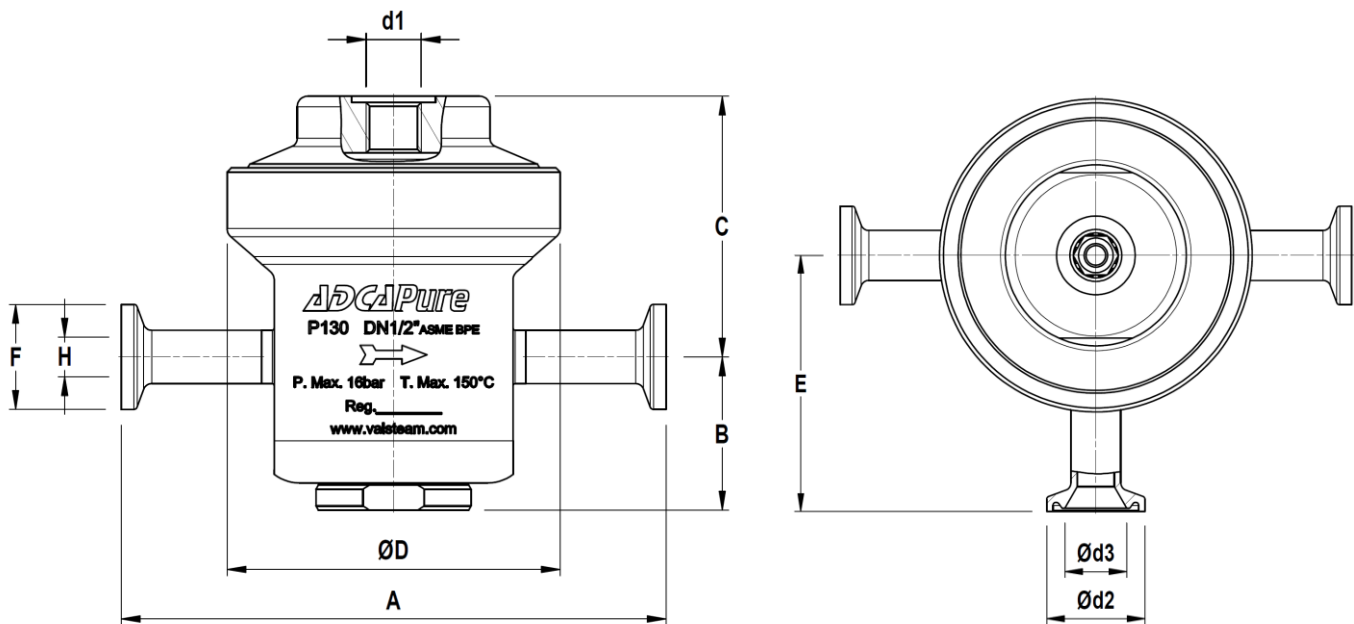

Optional pressure gauge connection.

MATERIALS		
POS. Nº	DESIGNATION	MATERIAL
1	Valve body	AISI 316L / 1.4404
2	Cover	AISI 316L / 1.4404
3	Seat cover	AISI 316L / 1.4404
4	* O-ring	Viton ; EPDM
5	* Piston	AISI 316L / 1.4404
6	* Valve head	AISI 316L / 1.4404 ; Viton ; PTFE
7	* Valve spring	AISI 316 / 1.4401 electropolished
9	Pusher disc	AISI 316L / 1.4404
10	* Lower diaphragm	PTFE (Gylon)
11	* Upper diaphragm	EPDM
12	Washer	AISI 304 / 1.4301
13	Spring plate	AISI 304 / 1.4301
14	Nut	Stainless steel A2-70

\* Available spare parts ; \*\* On request.

Remarks: FDA / USP Class VI seals certificate on request.

All valves have a serial number. In case of non-standard valves, this number must be supplied if spare parts are ordered.

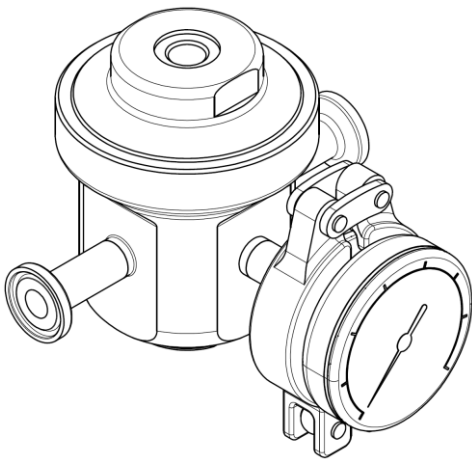
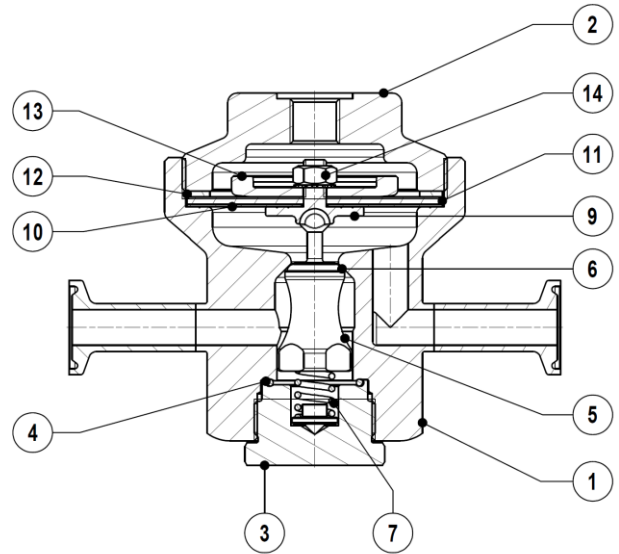

*Optional pressure gauge connection.*

ORDERING CODES P130A															
Valve model	P13	A	3	T	M	2	X	X	X	X	D	15	E		
P130A – AISI 316L / 1.4404 diaphragm sensing pressure reducing valve	P13														
<b>Outlet spring range</b>															
0,2 to 8 bar (dome loaded)		A													
<b>Flow capacity</b>															
Kvs – 0,6			1												
Kvs – 1			2												
Kvs – 1,7			3												
Kvs – 3			6												
<b>Diaphragm material</b>															
PTFE (Gylon)				T											
<b>Valve head</b>															
Metal to metal (non-standard)					M										
EPDM						E									
PTFE							T								
FPM / Viton								V							
<b>Dome connection</b>															
Female threaded ISO 7/1 Rp 1/4"												1			
Female threaded 1/4" NPT													2		
<b>Dome options</b>															
None														X	
I/P converter 0,2 to 8 bar output															C
<b>Gauge port options</b>															
Without gauge ports															X
Tri-clamp gauge port on the left side (rel. to the flow direction) – downstream pressure															7
Tri-clamp gauge port on the right side (rel. to the flow direction) – downstream pressure															6
Tri-clamp gauge port on both sides – downstream pressure															5
Threaded gauge port on the left side (rel. to the flow direction) – downstream pressure – 1/4" ISO 7/1 Rp															4
Threaded gauge port on the right side (rel. to the flow direction) – downstream pressure – 1/4" ISO 7/1 Rp															3
Threaded gauge port on both sides – downstream pressure – 1/4" ISO 7/1 Rp															2
Threaded gauge port on the left side (rel. to the flow direction) – downstream pressure – 1/4" NPT															W
Threaded gauge port on the right side (rel. to the flow direction) – downstream pressure – 1/4" NPT															Y
Threaded gauge port on both sides – downstream pressure – 1/4" NPT															Z
<b>Surface finish, special services and options</b>															
None (fine machined)															X
Mechanical polishing															P
Electropolishing															E
<b>Special features</b>															
None															X
Degreased for oxygen															O
<b>Pipe connection</b>															
Clamp ferrule ASME BPE															D
Clamp ferrule DIN (DIN 32676-A)															F
Clamp ferrule ISO (DIN 32676-B)															E
ETO according to ASME BPE															DI
ETO according to DIN 11966-A (DIN 11850-2)															FI
ETO according to ISO 1127-1															EI
<b>Size</b>															
DN 08															08
DN 10															10
1/2" or DN 15															15
3/4" or DN 20															20
1" or DN 25															25
<b>Special valves / Extras</b>															
Full description or additional codes have to be added in case of non-standard combination															E