

SANITARY PRESSURE REDUCING VALVE P130C (Clamped body)

DESCRIPTION

The ADCA P130C series direct acting, spring-loaded diaphragm sensing, pressure reducing valves are designed for use with clean air, nitrogen, carbon dioxide, oxygen, argon and other gases or liquids compatible with the construction materials and valve design.

This valve is specifically designed for the high purity gas systems found in the pharmaceutical, cosmetic, fine chemical and food & beverage processes.

MAIN FEATURES

- Compact design.
- Completely machined from 316L stainless steel bar stock, no castings or forgings are used.
- FDA / USP Class VI compliant seals.
- No rising stem.
- Clamped body.

STANDARD SURFACE FINISH

- Internal wetted parts: $\leq 0,51$ micron Ra – SF1.
- External: $\leq 0,76$ micron Ra – SF3.
- Other surface conditions see IS PV20.00 E – Technical information.
- Ultrasonic cleaning.

OPTIONS:

- Self relieving.
- Leakage line connection 1/8" (captured vent).
- Gauge connection on body.
- Different soft valves for liquids and gases.
- Wall mounting.

USE:

- Clean air, nitrogen, carbon dioxide, oxygen, argon and other gases or liquids compatible with the construction.

AVAILABLE

- MODELS: P130C.
- SIZES: 1/2" to 1"; DN 08 to DN 25.

OUTLET SPRING

- RANGES: 0,2 – 1,5 bar; 0,3 – 3 bar; 2 – 8 bar.

- CONNECTIONS: Clamp ends or others on request.

- PACKAGING: Assembling and packaging in a clean room certified according to ISO 14644-1. The product is end capped and sealed with recyclable thermo-shrinkable plastic film, to avoid contamination.

- INSTALLATION: Horizontal installation recommended.

ORDER

- REQUIREMENTS: Type of fluid.
- Maximum operating temperature.
- Inlet pressure and required outlet pressure capacity (maximum and minimum).



Cutaway view with pressure gauge connection

CE MARKING (PED – European Directive)	
PN16	Category
1/2" to 1" ; DN 08 to DN 25	SEP

LIMITING CONDITIONS	
Valve model	P130C
Body design conditions	PN16
Max. upstream pressure	16 bar
Max. downstream pressure	8 bar
Min. downstream pressure	0,2 bar
Max. design temperature *	150 °C

* Other on request.

DIMENSIONS (mm) ASME BPE											
SIZE	Kvs *	A **	B	C	Ø D	Ø d1	Ø d2 **	E	F	H	WEIGHT (kg)
1/2"	1,7	130	36,5	130	90	25	15,75	75	25	9,4	2,9
3/4"	3	130	36,5	130	90	25	15,75	80	25	15,75	2,9
1"	3	130	36,5	130	90	25	15,75	80	50,5	22,1	3,4

DIMENSIONS (mm) DIN											
SIZE DN	Kvs *	A **	B	C	Ø D	Ø d1	Ø d2 **	E	F	H	WEIGHT (kg)
10	1,7	120	36,5	130	90	25	15,75	75	34	10	2,9
15	3	120	36,5	130	90	25	15,75	75	34	16	3
20	3	120	36,5	130	90	25	15,75	80	34	20	3,1
25	3	120	38,5	128	90	25	15,75	80	50,5	26	3,4

Clamp ferrules DIN 32676 Series A; Tube weld DIN 11866 Series A (DIN 11850 Series 2).

DIMENSIONS (mm) ISO											
SIZE DN	Kvs *	A **	B	C	Ø D	Ø d1	Ø d2 **	E	F	H	WEIGHT (kg)
8	1,7	120	36,5	130	90	25	15,75	75	25	10,3	2,9
10	3	120	36,5	130	90	25	15,75	80	25	14	3
15	3	120	36,5	130	90	25	15,75	80	50,5	18,1	3,2
20	3	120	38,5	128	90	25	15,75	80	50,5	23,7	3,4

Clamp ferrules DIN 32676 Series B; Tube weld DIN 11866 Series B (ISO 1127 Series 1).

* Reduced Kvs on request.

** Special versions or non-standard sanitary clamp ferrules are available on request, both for the inlet/outlet and pressure gauge connection.

Valves with vinyl handwheel weights less 0,3 kg.

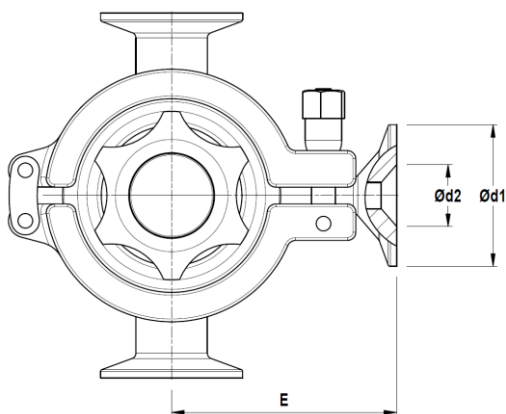

Pressure gauge connection.
(Optional)

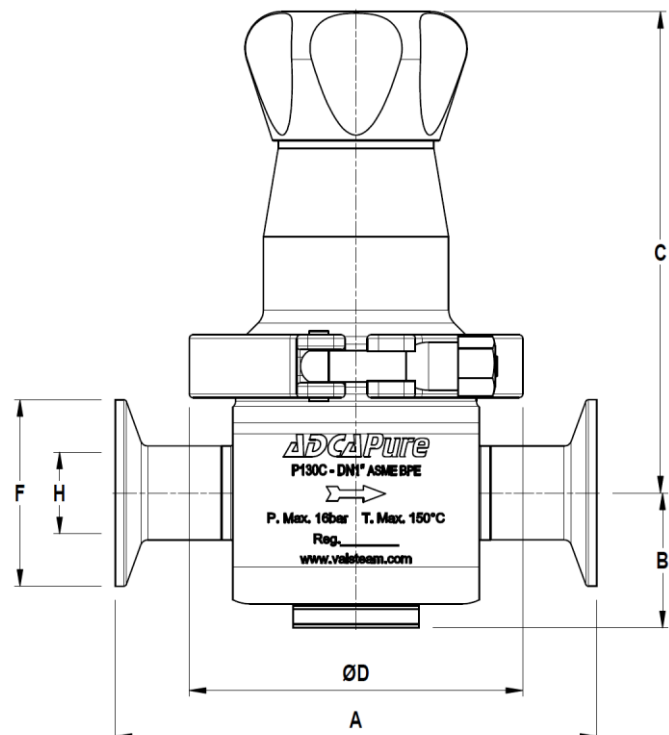

MATERIALS		
POS. Nº	DESIGNATION	MATERIAL
1	Valve body	AISI 316L / 1.4404
2	Cover	AISI 316L / 1.4404
3	Seat cover	AISI 316L / 1.4404
4	* O-ring	Viton ; EPDM
5	* Piston	AISI 316L / 1.4404
6	* Valve head	AISI 316L / 1.4404 ; Viton ; PTFE
7	* Valve spring	AISI 316 / 1.4401 Electropolished
9	Pusher disc	AISI 316L / 1.4404
10	* Lower diaphragm	PTFE (Gylon)
11	* Upper diaphragm	EPDM
13	Spring plate	AISI 304 / 1.4301
14	Nut	Stainless steel A2-70
15	* Adjustment spring	AISI 302 / 1.4300
16	Spring plate	AISI 304 / 1.4301
17	Adjustment screw	Brass
18	Retaining washer	Stainless steel A2-70
19	Handwheel	AISI 316L / 1.4404
		Vinyl
20	O-ring	NBR
21	** O-ring	EPDM
22	Bearing	Corrosion resistant steel
23	Ext. bowed shaft ring	Stainless steel
24	Cover nut	Plastic
25	Captured vent ring	AISI 316L / 1.4404
26	Clamp	AISI 316L / 1.4404

* Available spare parts ; ** On request.

Remarks: FDA / USP Class VI seals certificate on request.

All valves have a serial number. In case of non-standard valves, this number must be supplied if spare parts are ordered.

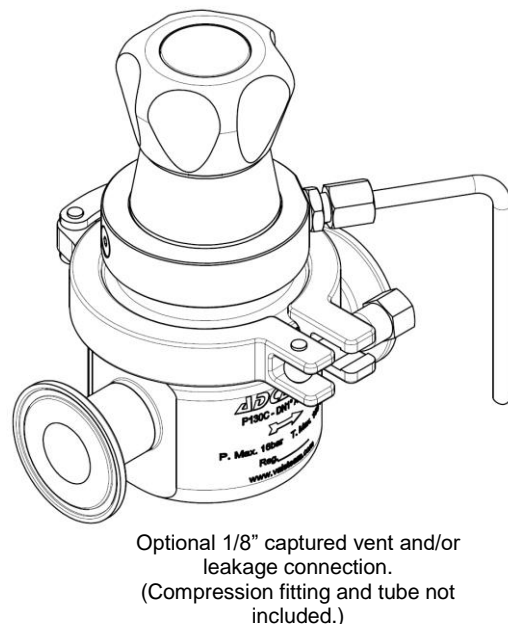
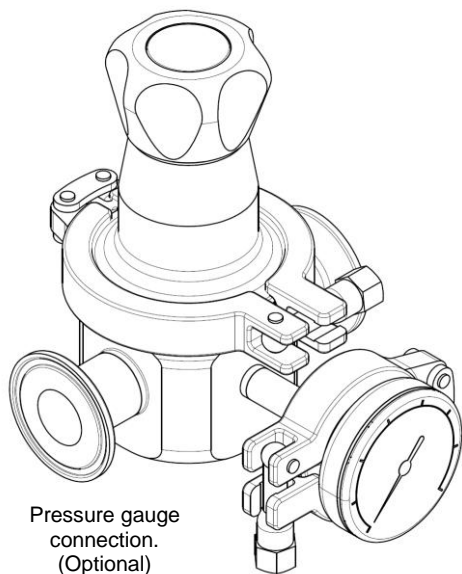
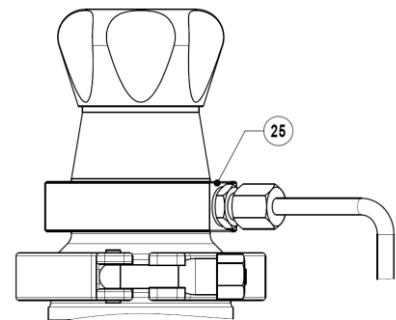
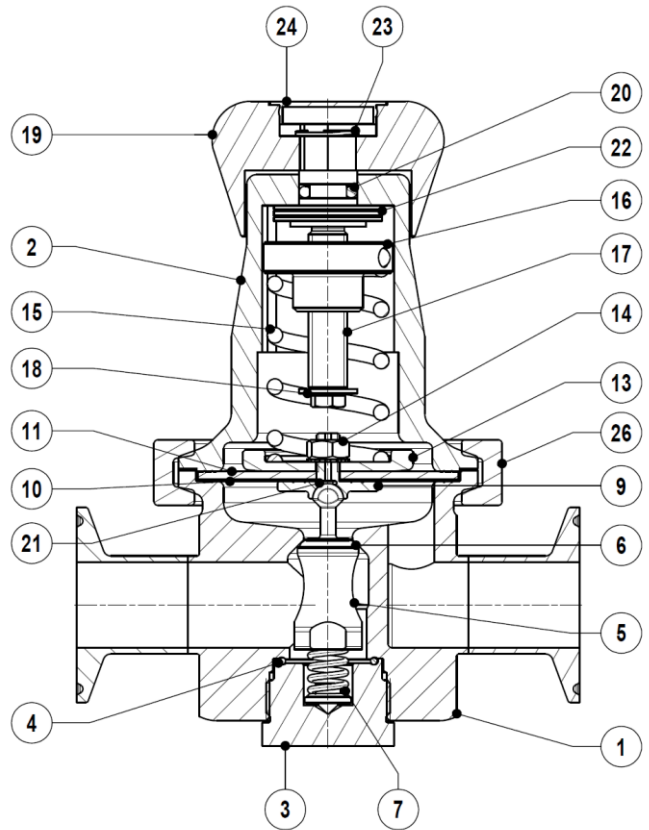

ORDERING CODES P130C														
Valve model	P13C	1	3	T	M	X	I	X	X	X	D	15	E	
P130C – AISI 316L / 1.4404 diaphragm sensing regulator	P13C													
Outlet spring range														
0,2 to 1,5 bar		1												
0,3 to 3 bar		2												
2 to 8 bar		3												
Flow capacity														
Kvs – 0,6		1												
Kvs – 1		2												
Kvs – 1,7		3												
Kvs – 3 (Only applicable to sizes 3/4", 1", DIN DN 15 to 25, ISO DN 10 to 20)		6												
Diaphragm material														
PTFE (Gylon)				T										
Valve head														
Metal to metal (non-standard)					M									
EPDM					E									
PTFE					T									
FPM / Viton					V									
Relieving														
Non-relieving						X								
Relieving (only for non-dangerous gases)						R								
Relieving with captured vent						L								
Regulating knob and top cap														
Stainless steel							I							
Plastic							P							
Top cap (adjusting screw sealing)							T							
Gauge port options														
Without gauge ports								X						
Tri-clamp gauge port on the left side (rel. to the flow direction) – Downstream pressure									7					
Tri-clamp gauge port on the right side (rel. to the flow direction) – Downstream pressure										6				
Tri-clamp gauge port on both sides – Downstream pressure											5			
Threaded gauge port on the left side (rel. to the flow direction) – Downstream pressure												4		
Threaded gauge port on the right side (rel. to the flow direction) – Downstream pressure													3	
Threaded gauge port on both sides – Downstream pressure														2
Surface finish, special services and options														
None (fine machined)										X				
Mechanical polishing											P			
Electropolishing												E		
Special features														
None												X		
Degreased for oxygen													O	
Pipe connection														
Clamp ferrule ASME BPE													D	
Clamp ferrule DIN (DIN 32676-A)													F	
Clamp ferrule ISO (DIN 32676-B)													E	
ETO according to ASME BPE													DI	
ETO according to DIN 11966-A (DIN 11850-2)													FI	
ETO according to ISO 1127-1													EI	
Size														
DN 08														08
DN 10														10
1/2" or DN 15														15
3/4" or DN 20														20
1" or DN 25														25
Special valves / Extras														
Full description or additional codes have to be added in case of non-standard combination													E	