

PISTON SENSING PRESSURE REDUCING VALVE PRV31SS 1" – 1 1/4"; DN 25 – DN 32

DESCRIPTION

The ADCA PRV31 series direct acting, spring-loaded piston sensing, balanced valve pressure reducing valves, are designed for use on compressed air, water and other gases or liquids compatible with the materials of the construction.

They are suitable for pressure reducing stations at the point of use on laundry machines, dyeing, food industries, sterilizers, etc.

Connections are female screwed or flanged.

MAIN FEATURES

Compact design.
Balanced valve.

OPTIONS:

Different soft valves for water and gases.
Relieving – Internal relief valve to allow reduced outlet pressure in a no-flow condition.
Outlet 1/4" gauge connection on body.
Regulating screw with top cap.

USE:

Compressed air, water and other gases and liquids compatible with the construction.

AVAILABLE

MODELS: PRV31SS – Stainless steel.

SIZES:

1" and 1 1/4".
DN 25 and DN 32.

CONNECTIONS:

Female screwed ISO7/1 Rp (BS 21) or NPT.
Flanged EN1092-1 PN40 – PN63.
Special flanges upon request.
Horizontal installation.

INSTALLATION:

An "Y" strainer should be installed upstream of the valve.
See IMI – Installation and maintenance instructions.

ORDER

REQUIREMENTS: Type of fluid.
Maximum operating temperature.
Inlet pressure and required outlet pressure.
Capacity (maximum and minimum).



CE MARKING – GROUP 2 (PED – European Directive)	
PN16 / PN63	Category
DN 25 to 32	SEP

CAPACITIES		
Valve size	1" – DN 25	1 1/4" – DN 32
Kvs (m ³ /h)	7,5	8,2

LIMITING CONDITIONS	
Valve model	PRV31SS
Body design conditions	PN63
Max. upstream pressure	50 bar
Max. downstream pressure	50 bar
Min. downstream pressure	3 bar
Max. design temperature *	80 °C
Max. recommended reducing ratio	40:1

* Other on request.

DIMENSIONS – CASTED VERSION (mm)							
Screwed				PN16/40			
SIZE	A	B	C	WGT. (kg)	D *	E	WGT. (kg)
1" – DN 25	105	60	320	8,6	160	57,5	10,7

* Different lengths on request.

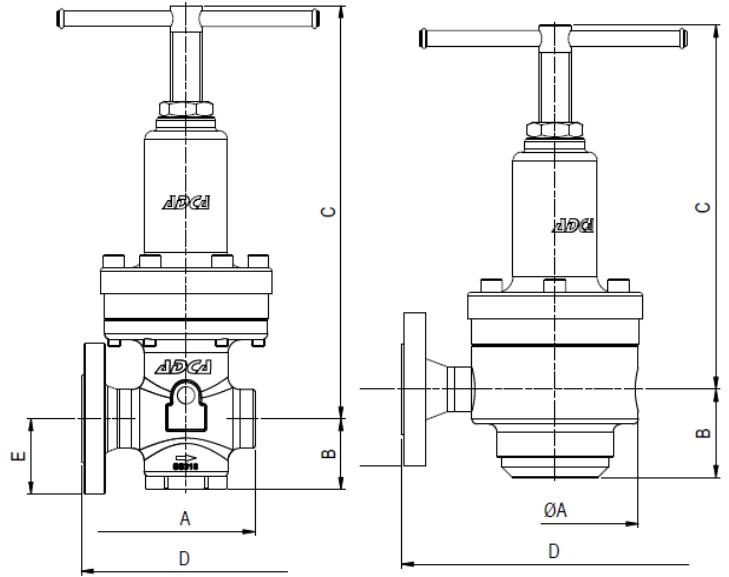

DIMENSIONS (mm) – BAR STOCK VERSION																	
Screwed					PN16/40			PN63/100			ANSI 150 lb			ANSI 300 lb			
SIZE	A	B	C	WGT. (kg)	D *	E	WGT. (kg)	D *	E	WGT. (kg)	D *	E	WGT. (kg)	D *	E	WGT. (kg)	
1" – DN 25	125	66	275	9,7	230	58	12	230	70	15	230	54	14	230	62	17	
1 1/4" – DN 32	125	66	275	9,7	260	70	14	260	78	17	260	59	15	260	67	18	

* Different lengths on request.

MATERIALS		
POS. Nº	DESIGNATION	MATERIAL
1	Valve body	AISI 316 / 1.4401 ; CF8M / 1.4408
1A	Piston sleeve	AISI 316 / 1.4401
2	Top cover	CF8M / 1.4408
3	Seat cover	AISI 316 / 1.4401
4	* O-ring	NBR
5	* Piston valve	AISI 316 / 1.4401
6	* Valve head	NBR ; EPDM ; PTFE ; etc.
6A	Pushrod	AISI 316 / 1.4401
7	* O-ring	NBR ; EPDM ; PTFE ; etc.
8	* Valve spring	AISI 302 / 1.4300
8A	* Strainer screen	AISI 304 / 1.4301
9	Piston	AISI 316 / 1.4401
9A	* O-ring	NBR ; EPDM ; PTFE ; etc.
9B	* O-ring	NBR ; EPDM ; PTFE ; etc.
13	Spring plate	AISI 304 / 1.4301
15	* Adjustment spring	Spring steel
16	Top spring plate	Brass
17	Adjustment screw	AISI 304 / 1.4301
18	Locknut	Stainless steel A2-70
20	Spring id. plate	Aluminium
21	Bolts	Stainless steel A2-70

* Available spare parts.

Remarks: All valves have a serial number. In case of non standard valves this number must be supplied if spare parts are ordered.

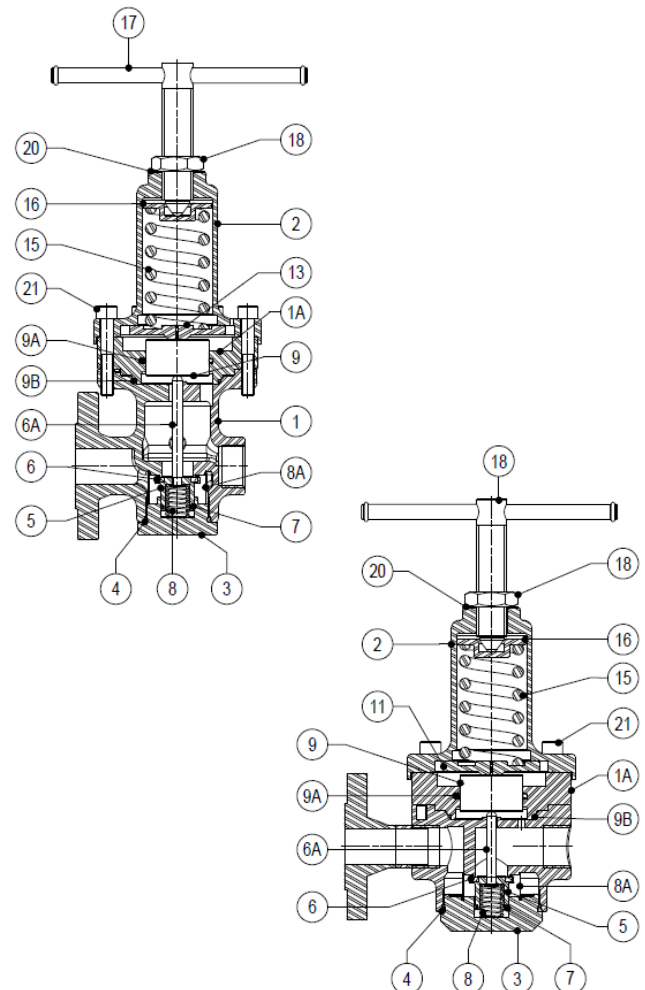

ORDERING CODES PRV31SS											
Valve model	R31	.	5	W	N	C		.	A		
PRV31SS – Piston sensing	R31										
Outlet spring range											
N°5 – 3 to 30 bar			5								
N°6 – 5 to 50 bar			6								
Application											
Water				W							
Gases				G							
Oxygen (degreased)				O							
Seal material											
NBR					N						
EPDM					E						
PTFE					T						
FPM / Viton					V						
Maximum inlet pressure											
30 bar						C					
50 bar						D					
Gauge port 1/4"											
Without gauge ports							(1)				
Gauge port on the left side (relative to the flow direction)							4				
Gauge port on the right side (relative to the flow direction)							3				
Gauge ports on both sides							2				
Relieving											
Non-relieving								(1)			
Relieving (only for non dangerous gases)								R			
Pipe connection											
Threaded BSP ISO 7/1									A		
Threaded NPT ANSI B1.20.1									C		
Socket weld SW ANSI B16.11									H		
Butt weld BW ANSI B16.25									I		
Flanged EN 1092-1 PN40									N		
Flanged EN 1092-1 PN63									O		
Flanged ANSI B16.5 150 lb									U		
Flanged ANSI B16.5 300 lb									V		
Flanged ANSI B16.5 600 lb									W		
Size											
1" or DN 25										25	
1 1/4" or DN 32										32	
Special valves / Extras											
Full description or additional codes have to be added in case of non-standard combination.											E

(1) Omitted if a standard valve is requested.