

## VACUUM BREAKER VB16

### DESCRIPTION

The VB16 vacuum breakers are simple and reliable devices that automatically relieve or “break” an unwanted vacuum condition, restoring the atmospheric pressure.

This device is particularly suitable for steam heated units of small and medium volume, such as heat exchangers, heating coils, calorifiers, jacketed kettles, steam boilers, etc.

Connections are male screwed.

- OPTIONS:** Stainless steel inlet deflector.
- USE:** Saturated steam and other gases compatible with the construction.
- AVAILABLE MODELS:** VB16.
- SIZES:** 1/2” to 1”.
- SET PRESSURE RANGES:** 0,05 – 0,10 bar; 0,09 – 0,20 bar; 0,19 – 0,30 bar; 0,29 – 0,40 bar; 0,39 – 0,50 bar.
- CONNECTIONS:** Screwed ISO 7/1 RP (BS21).
- INSTALLATION:** Vertical installation.  
 See IMI – Installation and maintenance instructions.
- LIMITING CONDITIONS:** 12 bar at 150 °C.  
 16 bar at 120 °C.

How to order: i.e. VB16 1/2” BSP (0,05 – 0,10bar).

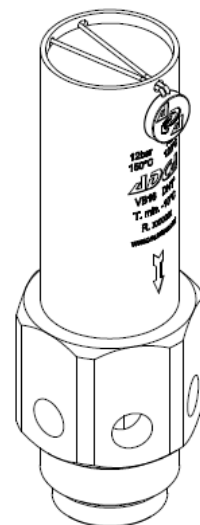
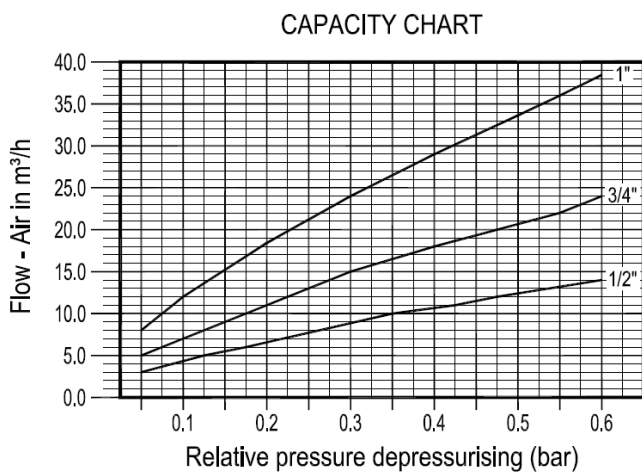

**DIMENSIONS (mm)**

| SIZE | A  | B   | C  | D  | E    | F    | G  | SW | WGT. (kg) |
|------|----|-----|----|----|------|------|----|----|-----------|
| 1/2" | 26 | 82  | 11 | 35 | 18   | 12,5 | 23 | 32 | 0,25      |
| 3/4" | 33 | 85  | 13 | 39 | 21   | 16,5 | 28 | 36 | 0,34      |
| 1"   | 33 | 108 | 15 | 45 | 27,5 | 20   | 35 | 41 | 0,51      |

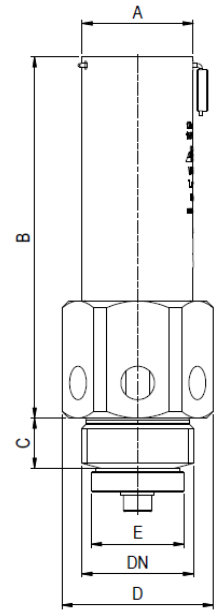
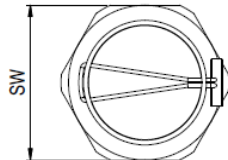

**MATERIALS**

| POS. Nº | DESIGNATION  | MATERIAL                  |
|---------|--------------|---------------------------|
| 1       | Body         | AISI 316 / 1.4401         |
| 2       | * Valve      | AISI 316 / 1.4401 ; Viton |
| 3       | Stem         | AISI 304 / 1.4301         |
| 4       | * Spring     | AISI 302 / 1.4300         |
| 5       | Spring guide | AISI 304 / 1.4301         |
| 6       | Nut          | A2-70                     |

\* Available spare parts;

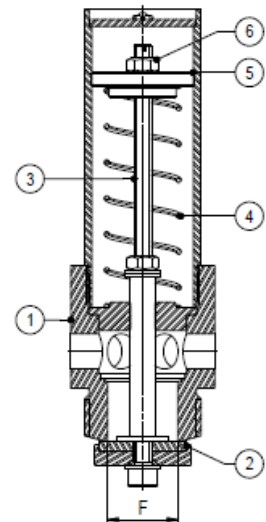

**TYPICAL INSTALLATION**

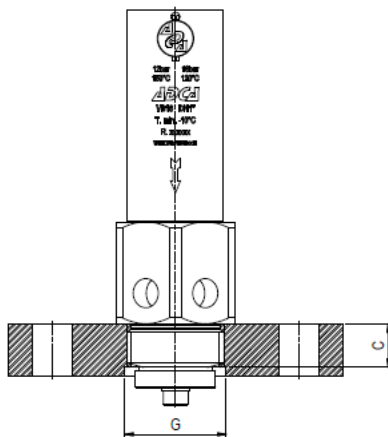

With flange

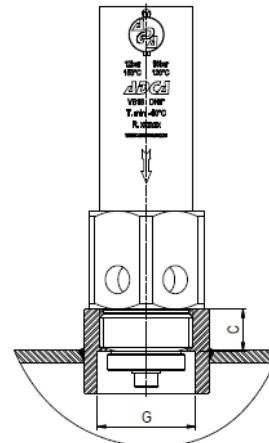

With socket