

Machining Tolerances	
Dimension	Tolerance
0.5–3	±0.1
>3–6	±0.1
>6–30	±0.1
>30–120	±0.3
>120–400	±0.5

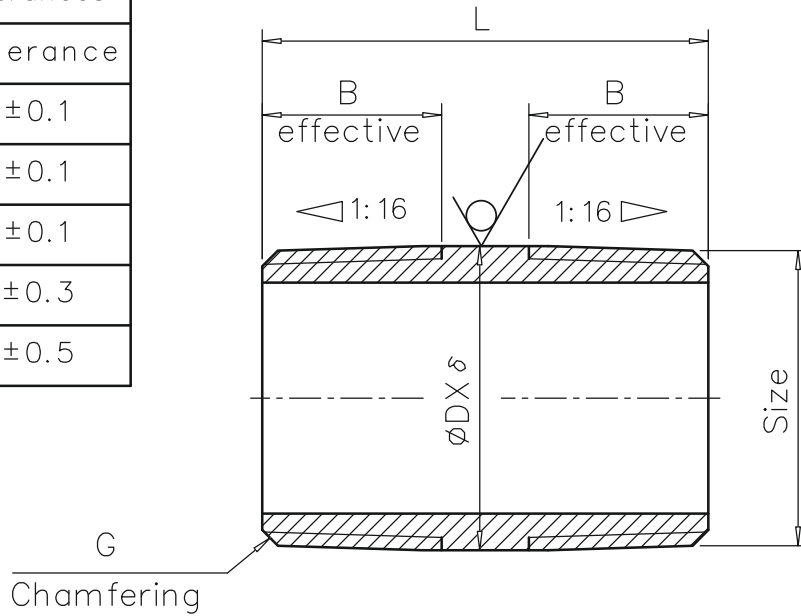

unit: mm

Size	L	B (effective)	G	ØDX δ	Weight
1/8"	40	10	1.2	Ø10.2X1.5	0.014
1/4"	40	10	1.2	Ø13.7X2.24	0.015
3/8"	40	10	1.2	Ø17.1X2.31	0.024
1/2"	55	13	1.2	Ø21.3X2.3	0.045
3/4"	60	15	1.2	Ø26.6X2.3	0.068
1"	65	17	1.5	Ø33.4X2.8	0.106
1-1/4"	75	19	1.5	Ø42.1X2.8	0.165
1-1/2"	75	19	1.5	Ø48.3X2.8	0.182
2"	90	23	1.5	Ø60.3X3.3	0.355
2-1/2"	100	27	1.5	Ø76.1X3.3	0.401
3"	110	30	1.5	Ø88.9X3.8	0.682
4"	125	36	1.5	Ø114.3X3.8	0.988
5"	150	41	1.5	Ø139.8x5	1.540
6"	180	41	1.5	Ø165.2x6	3.740